

TOP VIEW

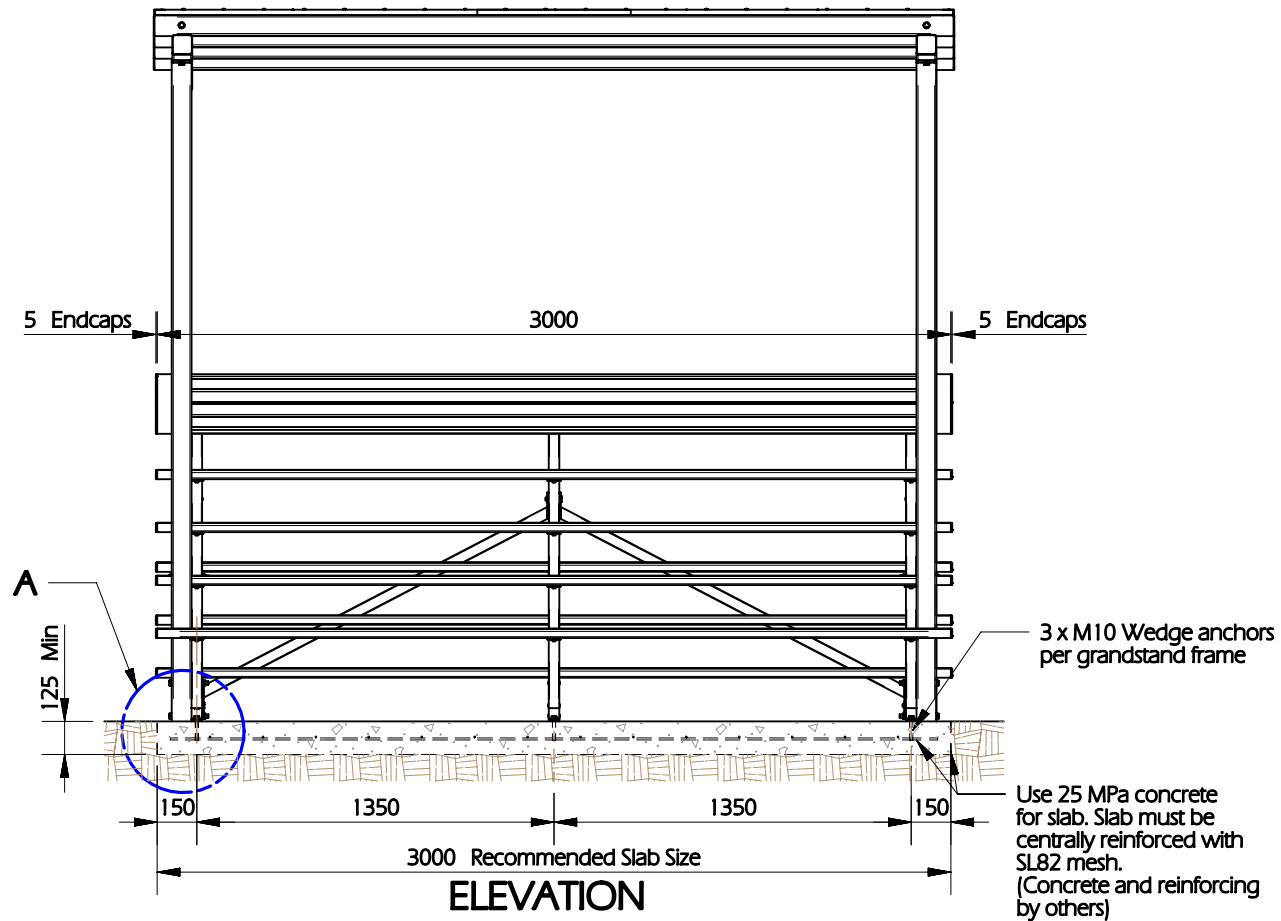

PICTORIAL VIEW



ELEVATION

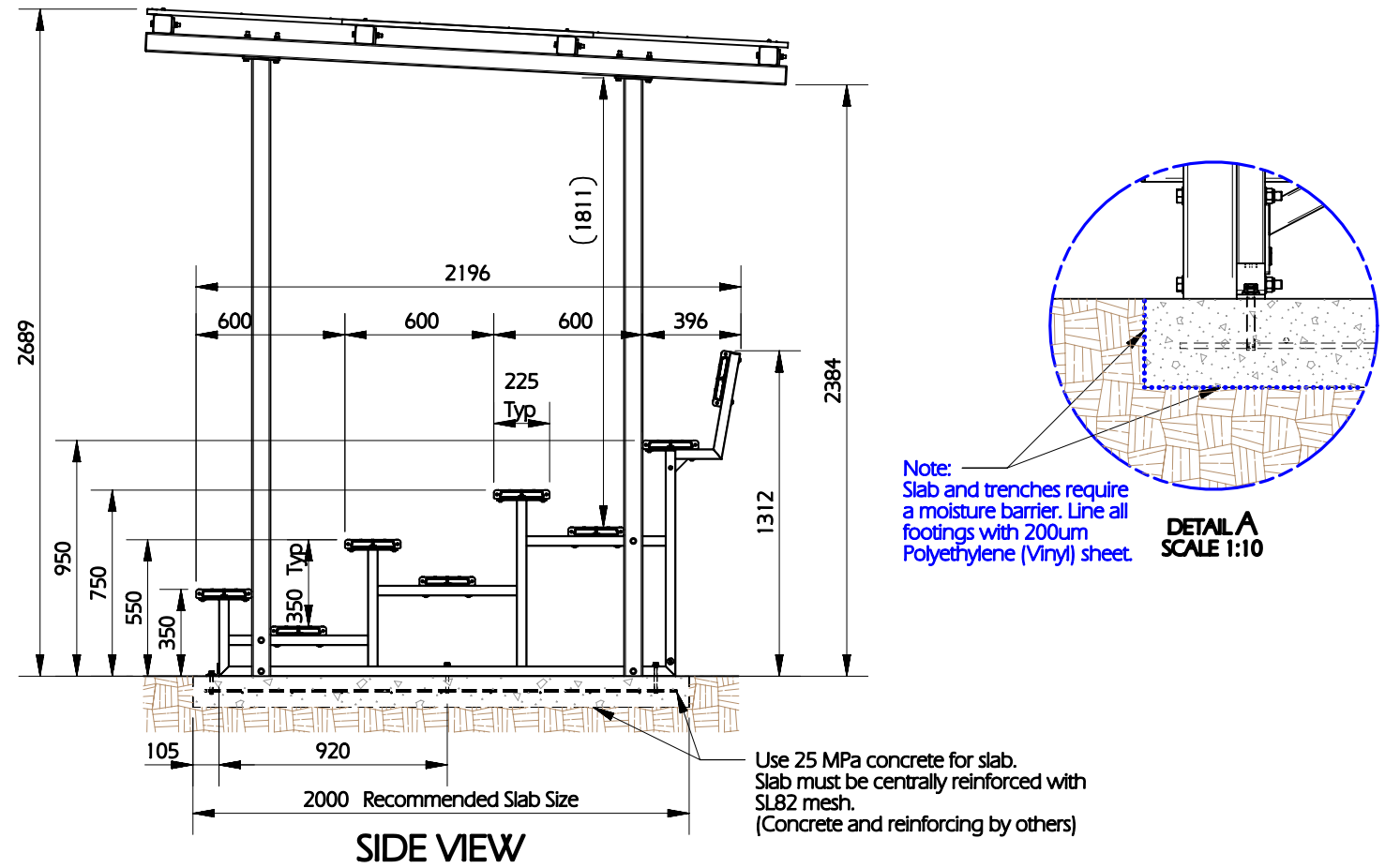

SIDE VIEW

GENERAL NOTES:

1. Slab & reinforcing designed for soil Class "P"
2. Slab & trench footings to be lined with 200um Polyethylene (Vinyl) sheet (by others)
3. Compact subgrade to 95% and minimum bearing capacity of 100kPa.