

Note: Slab and trenches require a moisture barrier. Line all footings with 200um Polyethylene (Vinyl) sheet.

**DETAIL A**  
SCALE: 1:10

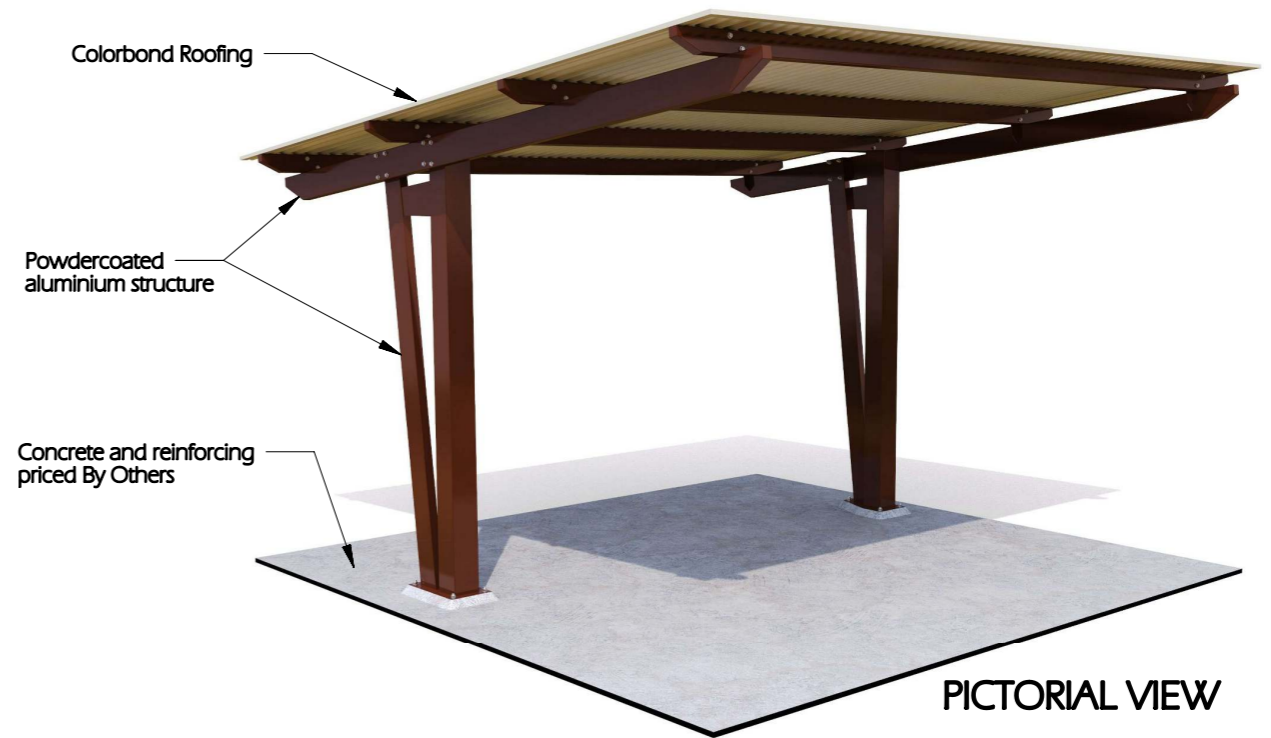

**PICTORIAL VIEW**

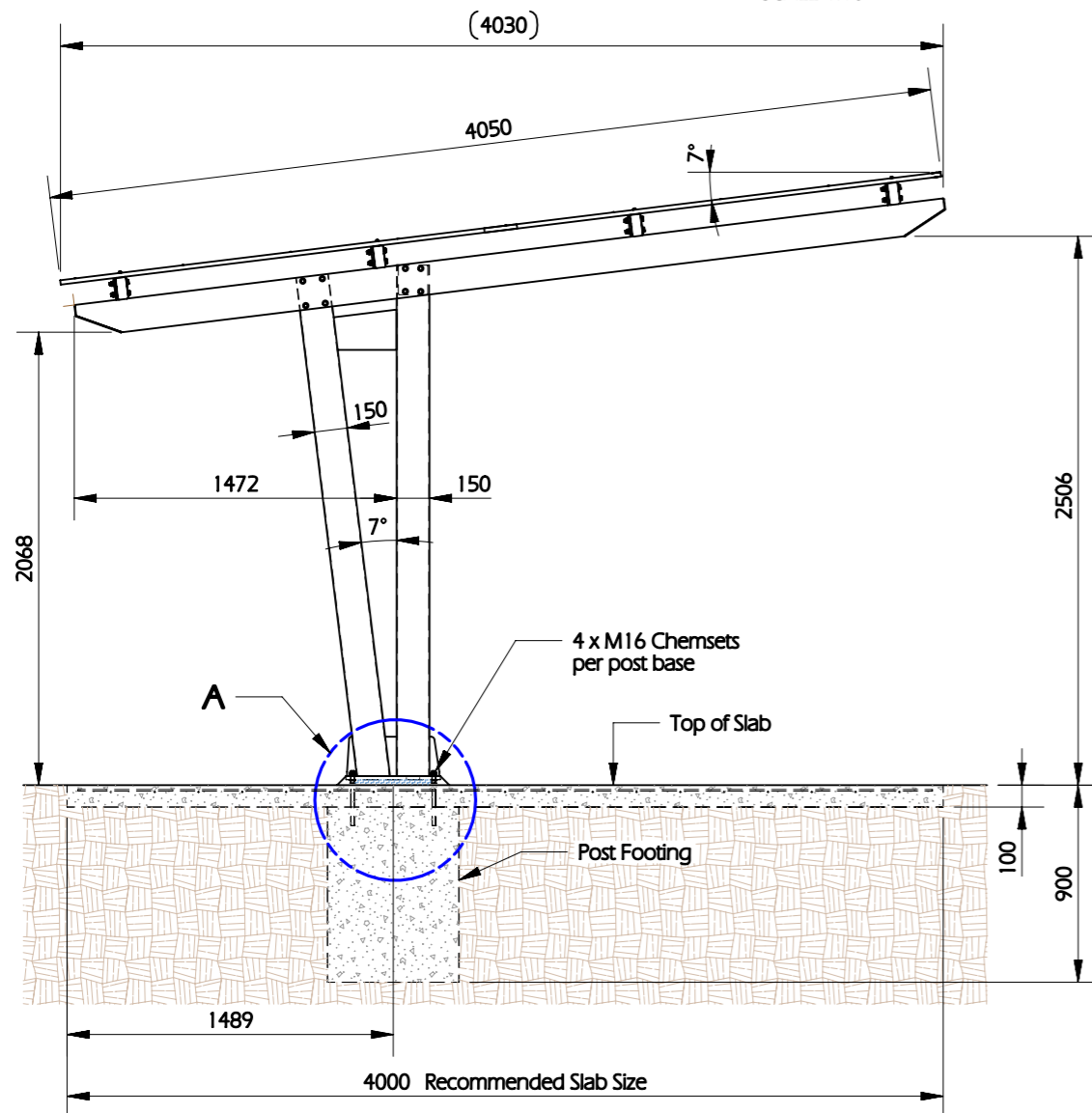

**SIDE VIEW**  
SCALE: NTS

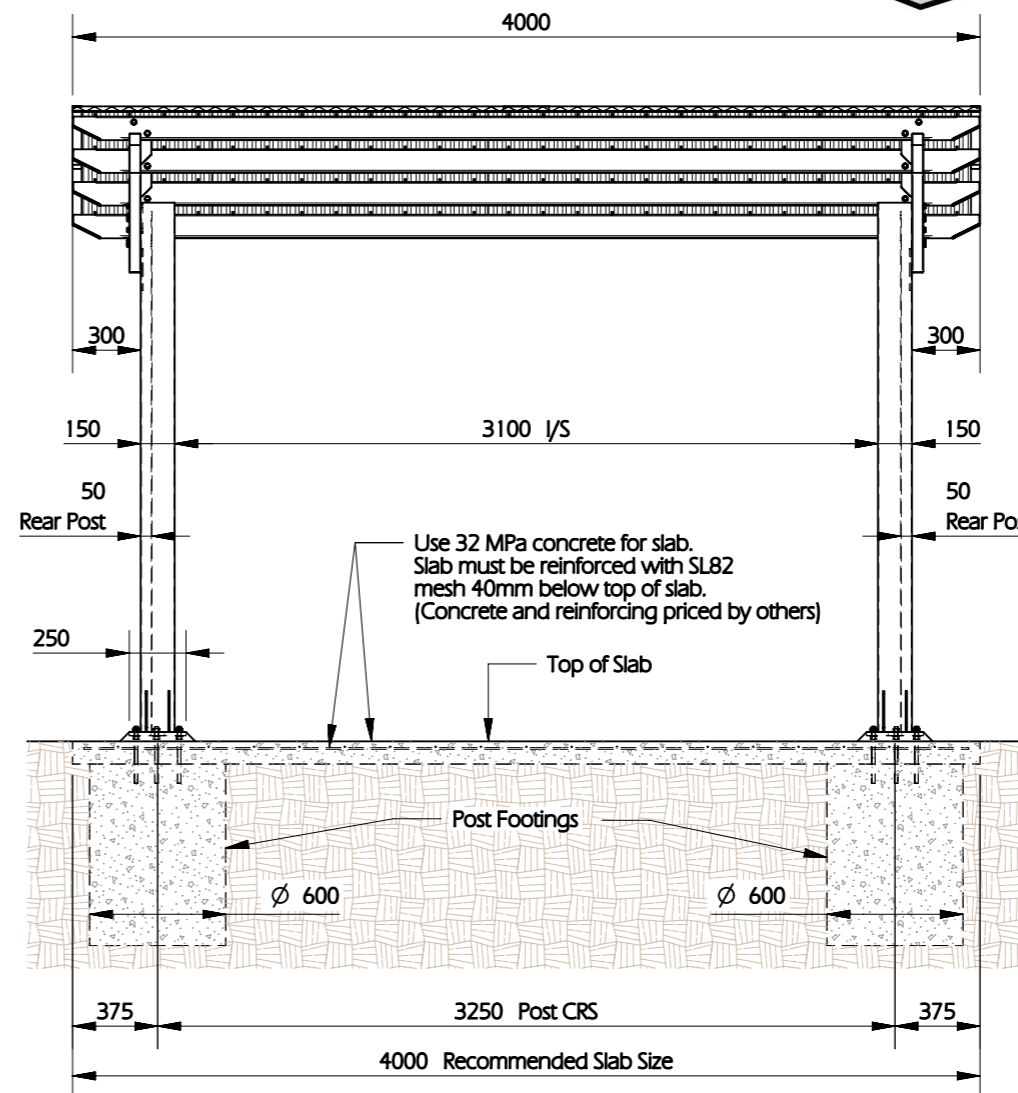

**FRONT VIEW**  
SCALE: NTS

1. Slab & reinforcing designed for soil Class "P"
2. Slab & trench footings to be lined with 200um Polyethylene (Vinyl) sheet (by others)
3. Compact subgrade to 95% and minimum bearing capacity of 100kPa. Deepen with 15MPa binding concrete if required.
4. ∅ 600 pile to be founded 500mm into natural soil capable of supporting 200kPa or 900mm below finished surface level whichever is deeper.